

# \$324,000 - Twp 225, Rural Wheatland County

MLS® #A2196475

**\$324,000**

0 Bedroom, 0.00 Bathroom,  
Land on 5.00 Acres

NONE, Rural Wheatland County, Alberta

5 acres with Mountain Views! Dream of getting out of the city and enjoy the prairie sunrises and sunsets. Build you dream homestead or start your own business or small farm. Strathmore is a short drive to the North East and South Calgary is just 20 minutes to the West. Carseland has the essentials just 10 minutes away as well. All the amenities including a hospital, many schools, golfing, swimming, restaurants, shopping and more are an easy commute with less than 1/2 mile of gravel. No building commitment & no restrictions. Schedule your viewing and explore the endless possibilities awaiting you. Property is about 1/2 mile south of Hwy 22X.

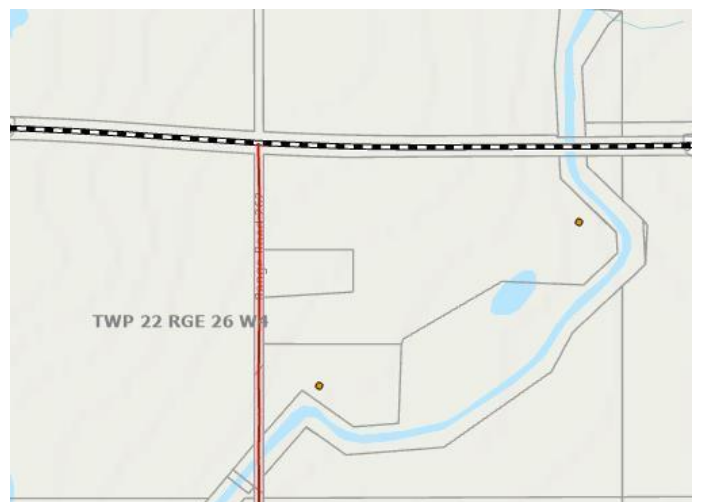

## Essential Information

MLS® #	A2196475
Price	\$324,000
Bathrooms	0.00
Acres	5.00
Type	Land
Sub-Type	Residential Land
Status	Active

## Community Information

Address	Twp 225
Subdivision	NONE
City	Rural Wheatland County
County	Wheatland County

Province	Alberta
Postal Code	T0J 0M0

### **Additional Information**

Date Listed	February 22nd, 2025
Days on Market	20
Zoning	AG

### **Listing Details**

Listing Office	RE/MAX Key
----------------	------------

Data is supplied by Pillar 9â,,ç MLSÂ® System. Pillar 9â,,ç is the owner of the copyright in its MLSÂ® System. Data is deemed reliable but is not guaranteed accurate by Pillar 9â,,ç. The trademarks MLSÂ®, Multiple Listing ServiceÂ® and the associated logos are owned by The Canadian Real Estate Association (CREA) and identify the quality of services provided by real estate professionals who are members of CREA. Used under license.